

CLASSIC | SELECTION

LAYOUTS AND COMPOSITION

STANDARD LAYOUTS

Can be also wallmounted.

Note: Sink bases and medicine cabinets are available separately

CENTERED

25" to 37" 37" to 43" 49" to 67"

61" to 79" 73" to 85" 85"

OFF-CENTERED

40" to 52" 43" to 55"

MIRROR WITH FRAME

WALLMOUNT MED. CABINET

RECESSED MED. CABINET

18" to 24", p.21

+ LINEN CABINET

12" to 18" 21" to 30" 13" to 16" 27" to 33"

LAYOUT EXAMPLES



+ EXTENDED CABINET OVER THE TOILET

MEDICINE CABINET AUXILIARY DRESSING TABLE

25" to 31" 25" to 31"

EXTENDED COUNTERTOP

WITHOUT DRAWER WITH DRAWER

25" to 31" 25" to 31"

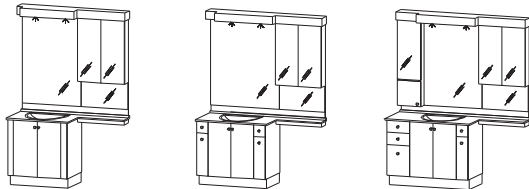

+ DRESSING TABLES

FIXED TO THE VANITY SEPARATED DRESSING TABLES

28" to 31" 28" to 31" 28" to 31" 37" to 43"



NOTE: RIGHT OR LEFT LAYOUTS.

CLASSIC | SELECTION

STANDARD LAYOUTS (available floormount or wallmount and right or left)

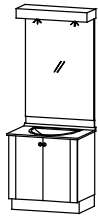

25" to 37"

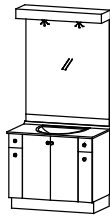

37" to 43"

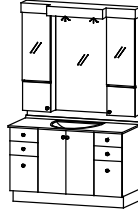

49" to 67"



40" to 52"

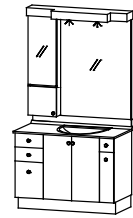

43" to 55"

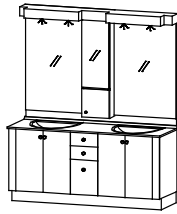

61" to 79"

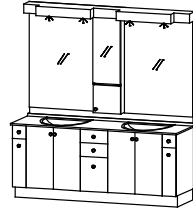

73" to 85"

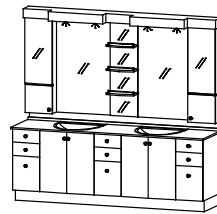

85"

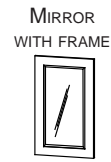

MIRROR WITH FRAME

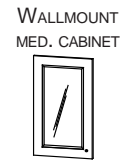

WALLMOUNT MED. CABINET



RECESSED MED. CABINET

18" to 24"

SUGGESTED LAYOUTS WITH LINEN CABINET

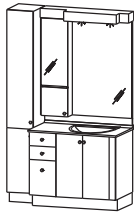

52" to 67"

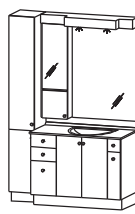

55" to 67"

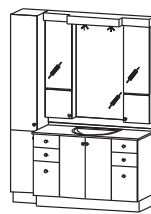

61" to 76"

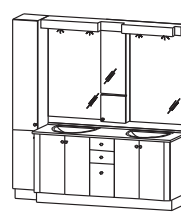

73" to 97"

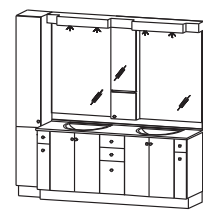

85" to 103"

SUGGESTED LAYOUTS WITH EXTENDED MEDICINE CABINET



55" to 67"

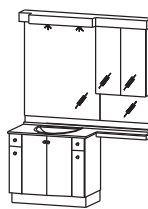

61" to 73"

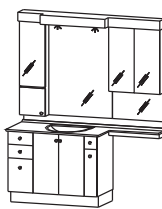

67" to 85"



79" to 91"

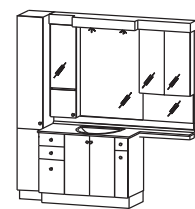

79" to 94"

SUGGESTED LAYOUTS WITH DRESSING TABLE



67" to 76"



70" to 79"



82" to 97"

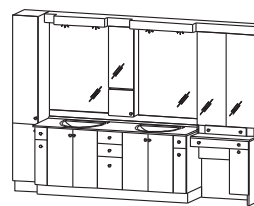

112" to 127"



28" to 31"

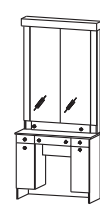

37" to 43"